



A PUBLICATION OF THE ADULT LOSS OF HEARING ASSOCIATION

# Hear & Now

November 2016  
Volume #19

ALOHA Annual Meeting  
& Election of Board  
Members

December 3rd @ 10:30

(Preceding Loretta's  
Celebration of Life)

All members are invited to  
attend this annual meeting  
at ALOHA.

Meet our board members,  
hear what they have to say  
about ALOHA, and vote for  
board candidates.



*All of us here at  
ALOHA wish you the  
merriest of holidays  
and a happy, healthy  
New Year!!!*

*Loretta Butler*

*Celebration of Life*

*December 3rd*

*11:30 am - 2:30 pm*



Please join the ALOHA Board of Directors and volunteers as we celebrate the life of our recently passed Office Coordinator, Loretta Butler. Loretta became a member of ALOHA in 1986 and devoted the next thirty years to helping those with hearing loss. Hers was the first voice you heard over the telephone and the first smile that greeted you at the door. Loretta has touched so many lives in different ways with a quiet voice and caring heart. We are hosting an informal open-house at ALOHA to share our memories and celebrate this amazing lady. We hope you will stop by for laughter and a light lunch.



**Saturday, December 3<sup>rd</sup> from 11:30 am – 2:30 pm**

Loretta's surviving children; Penny, John, Laura and Lenore, live out of state and are unable to attend this celebration. Cards for the family may be mailed to ALOHA, and should you desire, it is the family's wish that remembrance contributions be made to ALOHA.



Struggling with your holiday gift list?  
Relax!  
We have the perfect one-size-fits-all gift for  
you right here at ALOHA!

(You know where we are going with this, right?)

Postal carrier, hair dresser, dog sitter, employees, co-workers.....who would not want to pull up to Grandma's house Christmas morning driving a brand new 2016 Ford Mustang Shelby GT350?!!!

Did we mention we keep every penny?!!! That is really what it's all about. ALOHA provides invaluable services to people in Southern Arizona who struggle with hearing loss and we depend on our community's support. Let us make your shopping easy this year by participating in this fundraiser. Give the gift that keeps giving.

Your tickets are  
available at  
ALOHA until  
December 6th

Come see us soon!

**RAFFLE BENEFITING  
TUCSON CHARITIES**

**100% FOR LOCAL CHARITIES**

Win a NEW 2016 **FORD MUSTANG  
Shelby GT350!**

**TICKET PRICE  
\$25  
OR 5 FOR \$100**

*Exclusive:  
Only 4,300  
of these cars  
were made!*

**THE  
MILLIONS  
for  
TUCSON  
RAFFLE**

The Jim Click Automotive Team is presenting a new **2016 Ford Mustang Shelby GT350**, to the entire community...to be used as the featured prize in our on-going effort to raise millions of dollars for non-profit organizations in Greater Tucson.

With your **\$25** contribution (or 5 tickets for \$100) you could win a **2016 FORD MUSTANG SHELBY GT350!** The best part is that 100% of your contribution will support Greater Tucson charities - that keep all the proceeds from the maximum 100,000 tickets which will be sold. The drawing will be held on December 15, 2016. Entries must be received by December 9, 2016.

For campaign and ticket information, contact the Ford Mustang Raffle Team at 520.342.5210 or at: [mustang@russellpublic.com](mailto:mustang@russellpublic.com)

## **\* Support Groups \***

How Do Support Groups Help You?

Support groups empower people to work to solve their own problems.

Members act as role models for each other.

Members are equals.

Reduce anxiety, improves self-esteem and helps members' sense of well-being overall.

### **TUESDAY GROUPS @ ALOHA**

**1:00 - 2:00 pm and 7:00 - 8:00 pm**

Every week at ALOHA (4001 E. Ft. Lowell)

3rd Tuesdays Guest Speakers @ 1:00 pm  
(September thru May)

### **MONTHLY ALOHA MEETINGS:**

#### **Green Valley Peer Support Group:**

**1st Monday of the month 10:00 - 12 noon**  
(October thru May)

La Posada Recreation Room  
Contact: Martha Van Vactor 520-991-5791

#### **Sierra Vista Peer Support Group:**

**1st Monday of the month 11:00 - 12 noon**  
(Year-round)

Fry's Thrive - Mall at Sierra Vista, near Sears

Contact: Karl Hallsten  
SierraVistaALOHA@gmail.com

#### **Oro Valley Peer Support Group:**

**2nd Thursday of the month 2:00 - 3:00 pm**  
(October thru May)

Santa Catalina Catholic Church (Cholla & Octotillo Room) 14380 N. Oracle Road

Contact: Joan Eddy 520-825-8630  
eddyjoan@comcast.net

#### **East Side Peer Support Group:**

**3rd Friday of the month 1:00 - 2:00 pm**  
(October thru May)

Far Horizons - East (Main clubhouse)  
7570 East Speedway Blvd.

Contact: Jim Lootens 520-731-1993

#### **Desert Cochlear Connections\*:**

**2nd Saturday of the month 11:00 - 1:00pm**  
(October thru May)

ALOHA: 4001 E. Fort Lowell Road

Contact: Sue V. @ ALOHA 520-795-9887

\*CART transcription & loop amplification are provided at the DCC meetings.

#### **Cochlear Implant Company Monthly Meetings:**

Advanced Bionics: 3rd Thursday 1:00 - 3:00  
Cochlear Americas: 3rd Monday 1:00 - 4:00  
MED-EL: 2nd Thursday 10:00 - 3:00

*All meetings are FREE and open to the public. Meetings and presentations are subject to change with no notice. Refer to the website calendar and/or contact ALOHA for updated information.*



## DECEMBER CALENDAR OF EVENTS\*

December 3 <sup>rd</sup> (Sat.)	10:30 - 11:00 am	<u>Annual Meeting &amp; Election of Board Members</u>
December 3 <sup>rd</sup> (Sat.)	11:30 - 02:30 pm	<u>Loretta Butler – Celebration of Life</u> (Front page)
December 5 <sup>th</sup> (Mon.)	10:00 - 12:00 pm	Peer Support Group in Green Valley
December 5 <sup>th</sup> (Mon.)	11:00 - 12:00 pm	Peer Support Group in Sierra Vista
December 6 <sup>th</sup> (Tues.)	01:00 - 02:00 pm	Afternoon Peer Support Group @ ALOHA
December 6 <sup>th</sup> (Tues.)	07:00 - 08:00 pm	Evening Peer Support Group @ ALOHA
December 8 <sup>th</sup> (Thurs.)	02:00 - 03:00 pm	Peer Support Group in Oro Valley
December 9 <sup>th</sup> (Fri.)	10:00 - 03:00 pm	MED-EL information meeting <b>NOTE: Rescheduled from Thurs. Dec. 8<sup>th</sup></b>
December 10 <sup>th</sup> (Sat.)	11:00 – 01:00 pm	Desert Cochlear Connections Group
December 13 <sup>th</sup> (Tues.)	01:00 - 02:00 pm	Afternoon Peer Support Group @ ALOHA
December 13 <sup>th</sup> (Tues.)	07:00 - 08:00 pm	Evening Peer Support Group @ ALOHA
December 15 <sup>th</sup> (Thurs.)	01:00 - 03:00 pm	Advanced Bionics Coffee Chat
December 15 <sup>th</sup> (Thurs.)	<b>Canceled</b>	Sierra Vista Third Thursday Seminar
December 16 <sup>th</sup> (Fri.)	01:00 - 02:00 pm	East Tucson Peer Support Group @ Far Horizons
December 19 <sup>th</sup> (Mon.)	01:00 - 04:00 pm	Cochlear Americas informational meeting
December 20 <sup>th</sup> (Tues.)	01:00 - 03:00 pm	<b>Christmas Party</b> after Afternoon Support Group
December 20 <sup>th</sup> (Tues.)	07:00 - 08:00 pm	Evening Peer Support Group @ ALOHA
December 27 <sup>th</sup> (Tues.)	01:00 - 02:00 pm	Afternoon Peer Support Group @ ALOHA
December 27 <sup>th</sup> (Tues.)	07:00 - 08:00 pm	Evening Peer Support Group @ ALOHA
January 2 <sup>nd</sup> (Mon.)	<b>Rescheduled</b>	Peer Support Group in Green Valley <u>now Jan. 9th</u>
January 2 <sup>nd</sup> (Mon.)	<b>Canceled</b>	Peer Support Group in Sierra Vista

\* All events will be held at ALOHA unless specified otherwise. Events are subject to change without notice. Please contact the office and refer to our website for up-to-date calendar information.





# ALOHA Team Joins HLAA's Walk4Hearing

**Christmas Potluck Party  
@ ALOHA**

**Tuesday, December 20th**

**(after the 1:00 pm Peer Support Group)**



Doing your shopping on Amazon?

Use [Smile.Amazon.com](https://www.amazon.com/smile) and designate the Adult Loss of Hearing Association as your charity.

**Subscribe to updates**

Enter your email address below to receive notification when Aloha posts website updates.

Stay current! Go to our website [www.alohaaz.org](http://www.alohaaz.org) and subscribe to receive notifications whenever we post updates!

"Twenty-two ALOHA members and University of Arizona Speech, Language and Hearing Sciences students participated in the first Arizona Walk4Hearing on November 12th in Mesa, AZ. We drove from Tucson to Riverview Park in the early morning hours. We were rewarded by the sunny warmth of the day and "something for everybody"-- ponies, face-painting, and exhibitor booths. Most of all, we appreciated the camaraderie of people of all ages who joined in the Hearing Loss of Association of America's (HLAA's) Walk effort to make hearing loss a matter of national concern. HLAA statistics reveal that there are 48,000,000 people in the United States who are affected by a significant degree of hearing loss. We are veterans and others whose hearing has been damaged by noise; we are people with hereditary hearing loss; we are people who have lost hearing to illnesses or prescription drugs, we are people who have problems hearing from birth or who have progressive hearing loss, we are people who suddenly lose their hearing with no known cause.

After setting a goal of \$2000 for the Walk, we received donations of nearly \$4000. A BIG thank you to all of our donors. Checks and online donations are sent to HLAA Arizona Walk4Hearing with ALOHA written on the memo line. HLAAA gets 60% (10% of which they use to run the well-organized Walk) and ALOHA gets 40% of the final amount raised. ALOHA believes in the strong advocacy and setting of public policy that HLAA and its staff work on throughout the year. They are currently working hard to see that hearing aids get insurance coverage. ALOHA is here for you "in your own backyard" offering support, education and advocacy.



# Smoke Alarms Can Save Your Life!

- Do you have appropriate smoke alarms based on your needs?
- Are your smoke alarms working properly?
- Do you have a fire escape plan?

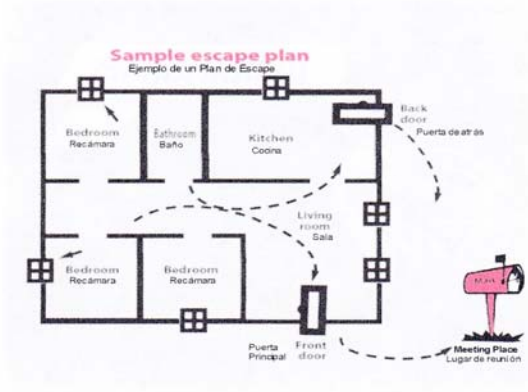

SERI is offering **free smoke alarms and installation** for the deaf and hard of hearing. These alarms must be plugged in to function; they are not hardwired.

**Sign-up at ALOHA, or Email or call SERI today to obtain more information about how you can get your smoke alarms.**

Aminata Kilungo or Ann Marie Wolf  
aawolf@seriaz.org  
520-321-9488



**Adult Loss Of Hearing Association, Inc.**

a support and advocacy organization

## Membership Form

*CATEGORIES	COST	LENGTH OF TIME
Individual Member	\$25.00	1 Year Membership (See below)
Family Membership	\$30.00	1 Year Membership (See below)
Business / Organization Member	\$75.00	1 Year Membership (See below)
Donation <i>(In addition to Membership)</i>	\$	
<b>Total Enclosed:</b>	\$	Make Check Payable to ALOHA (See address below)
<p><b>Note:</b> ALOHA is a non-profit organization in accordance with Section 501(c)(3) of the IRS Code.            Your donation may be tax deductible. Thank you for supporting ALOHA!!</p>		

<b>NAME</b> (First, MI, Last, Nickname):	
<b>Significant Other:</b>	
<b>Street Address:</b>	
<b>City, State, ZIP Code:</b>	
<b>Home Phone:</b>	
<b>Work Phone:</b>	
<b>Cell Phone Number:</b>	
<b>Email Address:</b>	

Emergency Contact Information (Optional, But Recommended):	
<b>Name:</b>	
<b>Phone:</b>	
<b>Relationship:</b>	

All members receive our "Hear & Now Newsletter" and receive discounts on classes we offer at ALOHA.

How do you want to receive your newsletter?     On-line     regular mail

Do you also want to receive the ALOHA e-Updater (our email newsletter)?    Yes     No

If a new member, how did you hear about ALOHA?

**Adult Loss Of Hearing Association - 4001 E. Fort Lowell, Tucson AZ 85712-1011**  
**(520) 795-9887      info@alohaaz.org**

Adult Loss Of Hearing Association  
(ALOHA)  
4001 E. Fort Lowell Road  
Tucson, AZ 85712-1011

Return Service Requested



ALOHA Board 2016

- Karl Hallsten, MSW, President
- Pamela Wood MS, CCC-A, Vice-President
- Stan Kruggel, Treasurer
- Cynthia Amerman, MSW, Secretary
- Ebba Andersen, BA, M.Ed
- Kimberly August
- Nicole Denny
- Bob Dorson
- Dale Henson, BA, MA
- Cristi Moore, Au.D.
- Mary Neff, Ph.D.
- Carolyn Olson
- Bruce Stewart, MD
- Susan Vardon, BA, MA
- Sherry Whitfield

**Office Hours: Tues - Thurs 10 AM to 4 PM**

**Please call in advance to confirm hours.**

**You can reach us at:**

Telephone: (520) 795-9887  
email: [info@alohaaz.org](mailto:info@alohaaz.org)  
Website: [www.alohaaz.org](http://www.alohaaz.org)

**Non-profit Tax ID# 86-0554154**

Adult Loss of Hearing Association—ALOHA

